

CONTACTS TO FIT Ø4mm HOLE

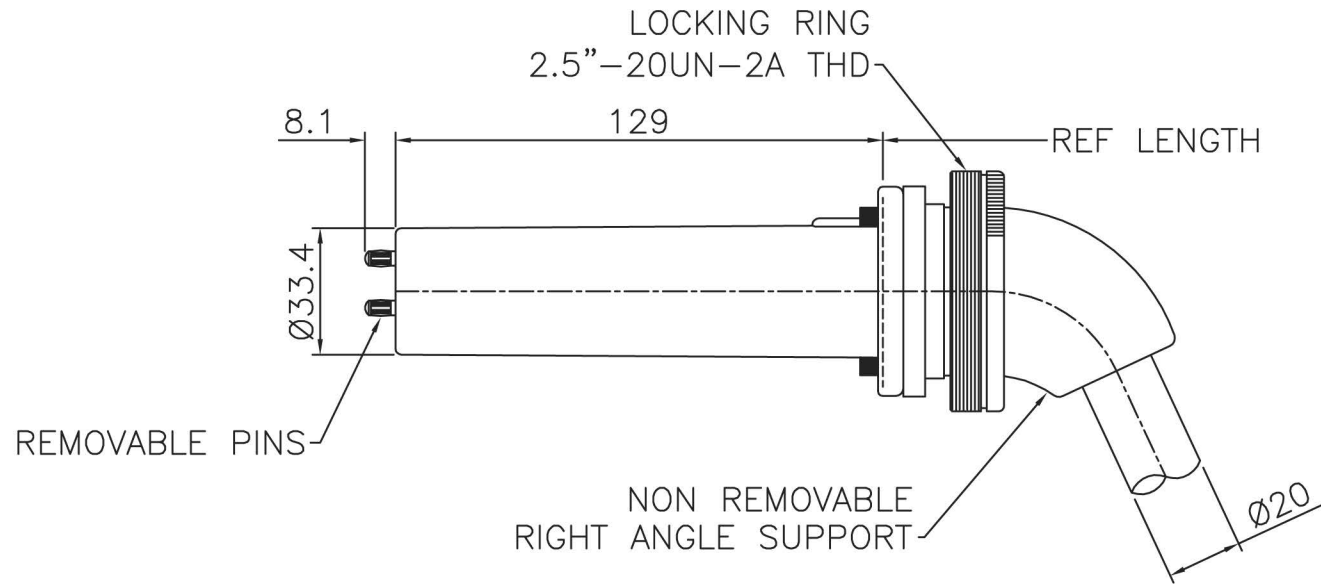
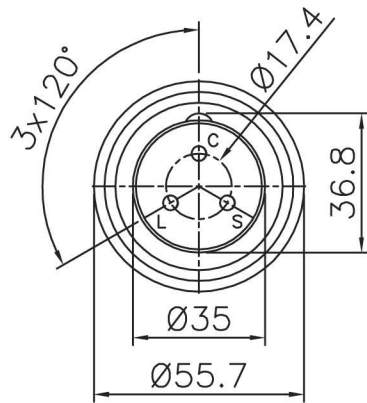

ESSEX PART NUMBERS
A36008/XXM
CABLE TYPE C2212

THIS DATA SHEET IS FOR IDENTIFICATION
PURPOSES ONLY. NOMINAL DIMENSIONS IN MM.

TECHNICAL DATA:

TERMINATION:-

NOMINAL OPERATING VOLTAGE 75KV
CABLE LENGTH TOLERANCE +/- 100mm
SOLID RESIN TERMINATION.

CABLE:- VOLTAGE WITHSTAND 100KV DC
65KV (RMS) AC

FOR FULL CABLE DATA SEE ESSEX CABLE DATA SHEET
NO. DS 1001

ACCESSORIES:

PIN REPLACEMENT KIT P00432
INSTALLATION GREASE P00075

INSTALLATION:

WARNING:
CABLE SHOULD ONLY BE FITTED BY A TRAINED PERSON.
CABLE CAN RETAIN ELECTRICAL CHARGE.
DISCHARGE TO EARTH BEFORE HANDLING.
A SUITABLE HIGH VOLTAGE GREASE SHOULD BE
APPLIED TO THE TERMINATION.

ENSURE THAT THE TERMINATION IS FULLY INSERTED
IN THE SOCKET BEFORE SECURING THE LOCKING RING.
AFTER INSTALLATION FULLY TIGHTEN LOCKING RING
TO PREVENT UNAUTHORISED DISCONNECTION.

ESSEX

Dandong Light Electric Co.,Ltd
Rm.1606 Jiadi Square,No.64,Binjiang Middle Rd,
Zhenxing, Dandong, Liaoning China
T:0415-6123232
F:0415-6123533

REVISIONS

NO.	DATE	BY

DUE TO CONTINUING PRODUCT DEVELOPMENT ESSEX X-RAY RESERVES THE RIGHT TO MODIFY DATA WITHOUT NOTICE

DRAWN	APPROVED	DATE	ISSUE	SCALE
MGM		05.06.08	1	N.T.S.

© NOT TO BE REPRODUCED IN WHOLE OR PART WITHOUT
PRIOR PERMISSION OF ESSEX X-RAY & MEDICAL EQUIPMENT LTD.

TITLE

3 PIN 75KV TERMINATION SOLID PLUGS
WITH RIGHT ANGLE SUPPORT ON C2212

DRAWING No.

DS1072