

ORIENTATION OF PINS IN
RELATION TO CUT OUT IN
FLANGE.

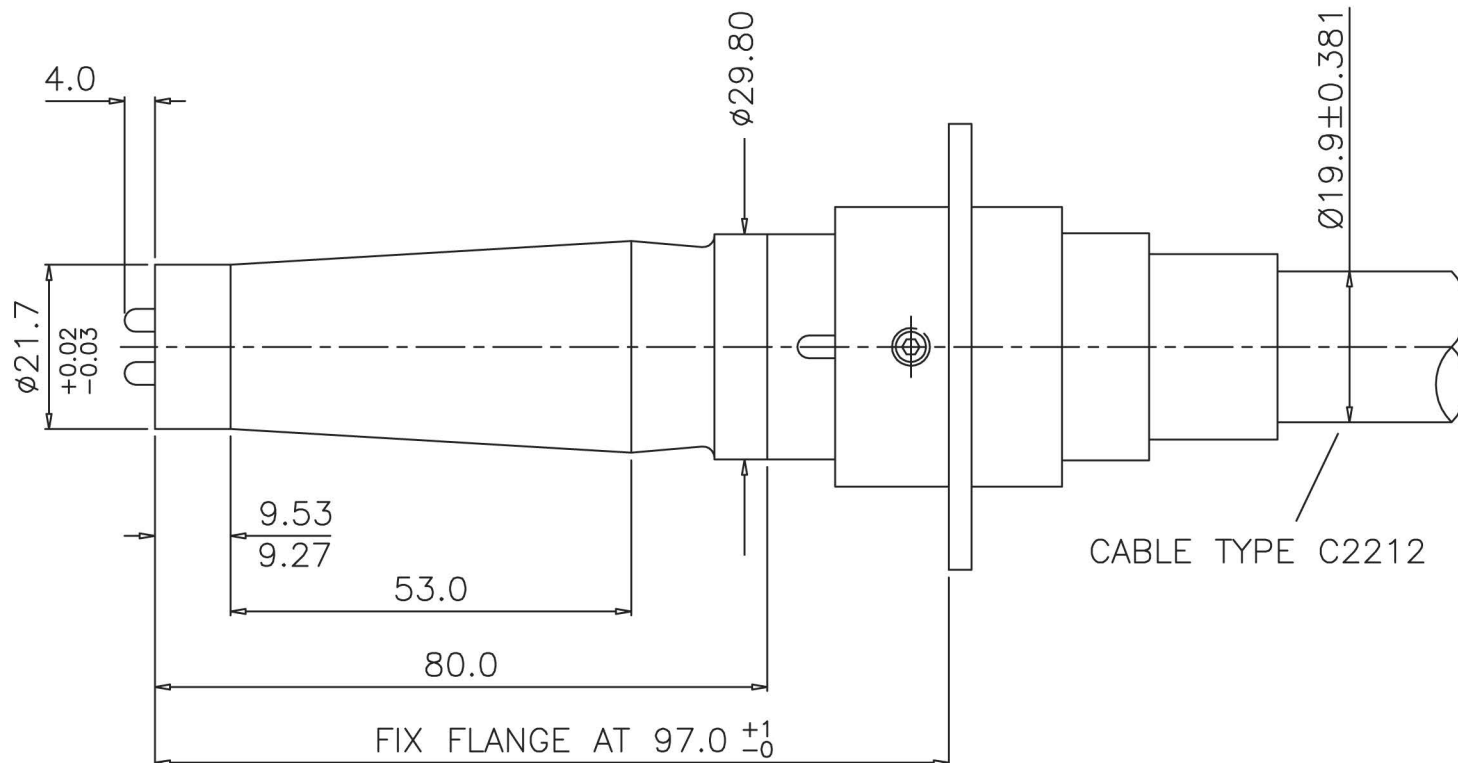

CABLE TYPE C2212

THIS DATA SHEET IS FOR IDENTIFICATION
PURPOSES ONLY. NOMINAL DIMENSIONS IN MM.

TECHNICAL DATA:

ACCESSORIES:

INSTALLATION:

TERMINATION:

NOMINAL OPERATING VOLTAGE 100KV DC
CABLE LENGTH TOLERANCE +/- 100mm

CABLE:

VOLTAGE WITHSTAND 100 KV DC
30 KV AC (RMS) Δ Δ
FOR FULL CABLE DATA SEE ESSEX CABLE DATA Δ Δ

CLAMPING SLEEVES:-

INSTALLATION GREASE P00075

WARNING:

CABLE SHOULD ONLY BE FITTED BY A TRAINED
PERSON. OIL MUST NOT BE USED ON THE RUBBER
TERMINATION ONLY SUITABLE HIGH VOLTAGE GREASE.

ESSEX

Dandong Light Electric Co.,Ltd
Rm.1606 Jiadi Square, No.64, Binjiang Middle Rd,
Zhenxing, Dandong, Liaoning China
T:0415-6123232
F:0415-6123533

REVISIONS

NO.	DATE	BY
2	14.07.99	DCN 1049
3	11.05.01	DCN 1455
4	09.03.09	DCN 2905

DUE TO CONTINUING PRODUCT DEVELOPMENT ESSEX X-RAY RESERVES THE RIGHT TO MODIFY DATA WITHOUT NOTICE

DRAWN	APPROVED	DATE	ISSUE	SCALE
MGM		16.07.98	4	N.T.S.

© NOT TO BE REPRODUCED IN WHOLE OR PART WITHOUT
PRIOR PERMISSION OF ESSEX X-RAY & MEDICAL EQUIPMENT LTD.

TITLE

100KV R27 TERMINATION
(CABLE TYPE C2212)

DRAWING No.

DS1033